

NOT FOR REPRODUCTION

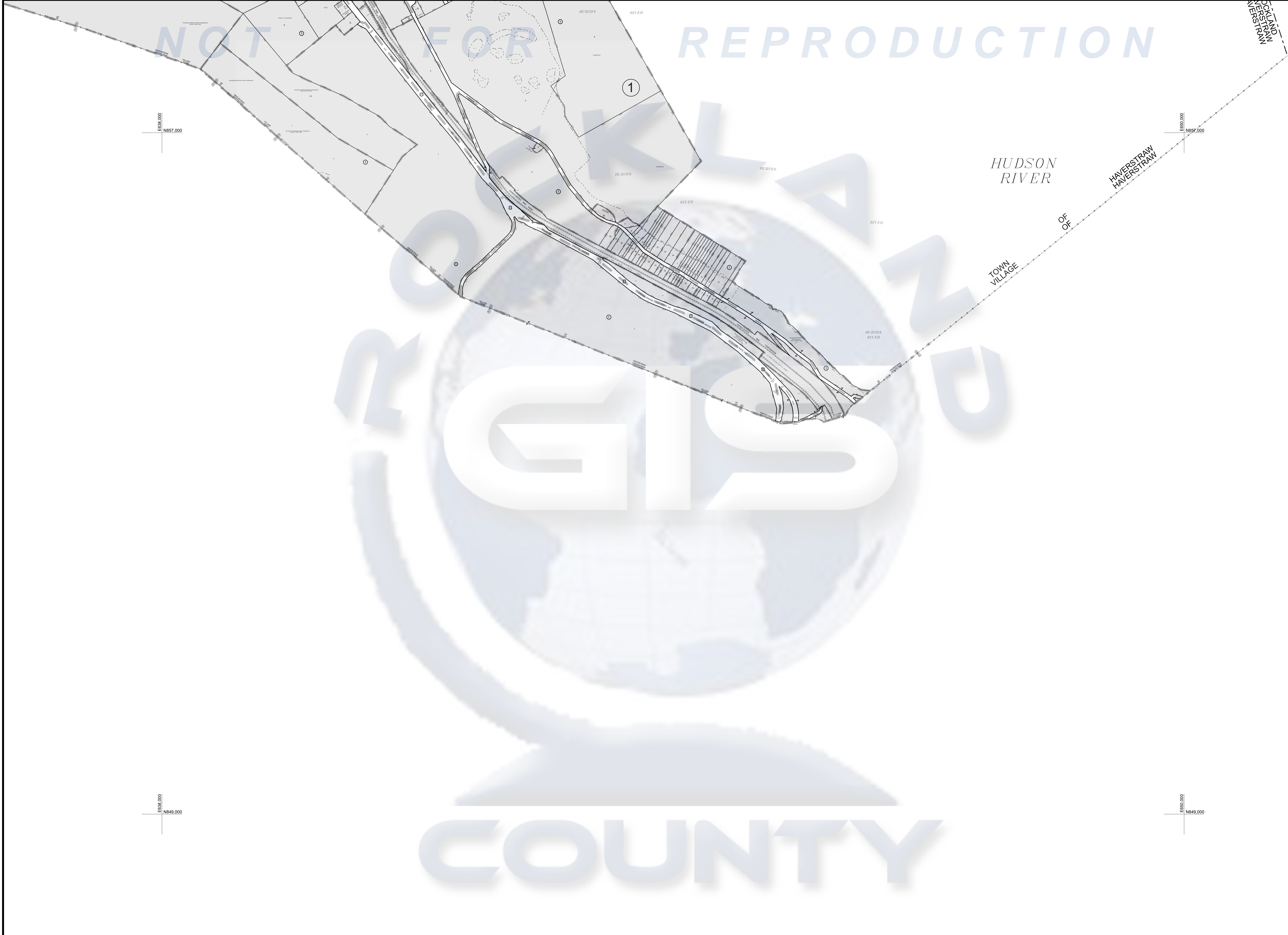

E850,000
N857,000

E850,000
N857,000

E850,000
N849,000

E850,000
N849,000

ROCKLAND COUNTY

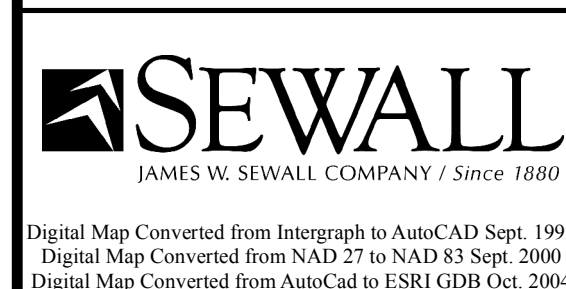

MAP REVISIONS					
DATE	MADE BY	REVISIONS	DATE	MADE BY	REVISIONS

SCHOOL AND SPECIAL DISTRICTS	
SCHOOL N. ROCKLAND 392201	
FIRE: THILLAROSEVILLE FD221	
SEWER: 30-45 SW223	
LIBRARY: KINGSDAUGHTERS 392293	
AMB: HAVERSTRAW: H4261	

COUNTY OF ROCKLAND	
AMBULANCE DIST.	—▲—
FIRE DIST.	— —
SEWER DIST.	—○—
WATER DIST.	—□—
SCHOOL DIST.	—□—
REFUSE DIST.	—R—
LIBRARY DIST.	—L—
LIGHTING DIST.	—L—

LEGEND	
HISTORIC SUBDIV. LINE	— - - - -
SENIOR COMMON OWNER	—+—
COUNTY LINE	—+—
STATE LINE	—+—
TOWN LINE	—+—
VILLAGE LINE	—+—
TAX MAP PARCEL NO.	43
COORD. VALUES (40-10-44)	+
PROPERTY LINE	—
ROAD ROW	—
UNSPECIFIED RR ROW	—
BLOCK LIMIT LINE	—
GAS/POWER	—
SEWER EASEMENT	—
WATER COURSE	—
EASEMENT LINE	—

TAX MAP BLOCK NUMBER	
REPLICATED DIMENSION/ACRE	+
DEED ACRES	1.03A
CALCULATED ACRES	1.03A
DEED DIMENSION	90
SCALED DIMENSION	90 (S)
ADD. REFERENCE DIMS.	(S)
HISTORIC SUBDIV. LOT NO.	39

26.20	27.00
-------	-------

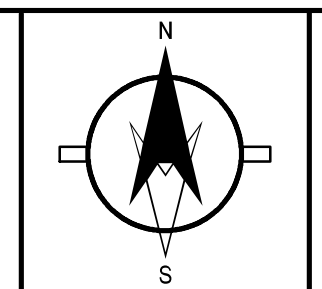

TAX MAP
VILLAGE OF HAVERSTRAW
ROCKLAND COUNTY, NEW YORK

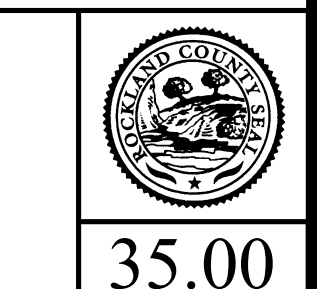

REVISED THROUGH
FEBRUARY 28, 2013
This map was prepared for TAX PURPOSES only and is not to be reproduced or used for surveying or conveyancing.